

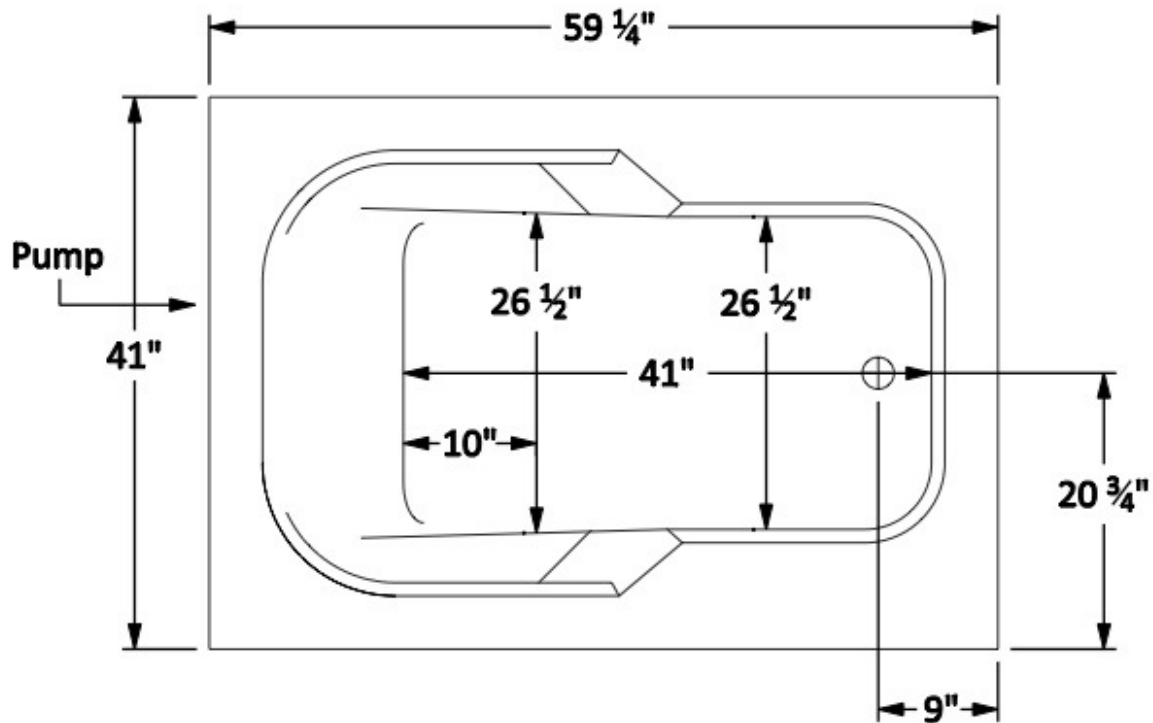

**CW4260**  
**CT4260** (*Soaking Tub Only*)



**Standard Equipment Specifications:**

- Whirlpool 6 Jet 1.5HP(120V/15A GFCI)
- Height Bottom of Flange to Floor 19" (Thermal Air Units 20")
- Maximum Water Depth 11-3/4"
- Operating Capacities: Min: 42g Max: 65g
- 20 Year Limited Warranty
- Measurements Vary +/- 1/4"

**Optional Equipment Specifications:**

- Constaheat Electric In-Line Heater 1.5KW (Requires Own 120V/15A GFCI)
- Thermal Air Massage 108 Air Inlet 1HP Air Blower (Requires Own 120V/15A GFCI)